



JOHNFORD

Vertical Machining Centers



VMC-1300/1300HD/1300-2H
VMC-1600/1600HD/1600S/1600SHD
VMC-2000S/2000SHD/3000S/3000SHD

Vertical Machining Center



VMC-1300 / 1300HD / 1300-2H

Item	Model	VMC-1300	VMC-1300HD	VMC-1300-2H
Table working surface		1500 x 750 mm (59.1" x 29.5")		
X-axis travel		1300 mm (51")		
Y-axis travel		850 mm (33.5")		
Z-axis travel		800 mm (31.5")	710 mm (28")	
Spindle motor		11 / 7.5 kW	18.5 / 15 kW	15 / 11 kW
Table load capacity		3270 kg (7100 lb)		
Machine dimensions (LxWxH)		3800 x 4525 x 3560 mm (149.6" x 178.1" x 140.2")	3800 x 4525 x 3220 mm (149.6" x 178.1" x 127")	
Machine weight		13500 kg (29700 lb)	14000 kg (30800 lb)	

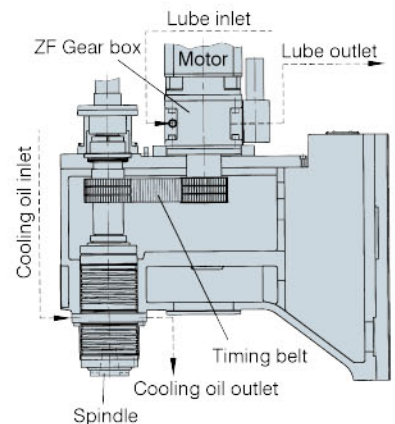

HD Type With ZF Gear Box



↗ **Twin Spindle Head-2H**

- The distance between two spindle centerlines is 635 mm.

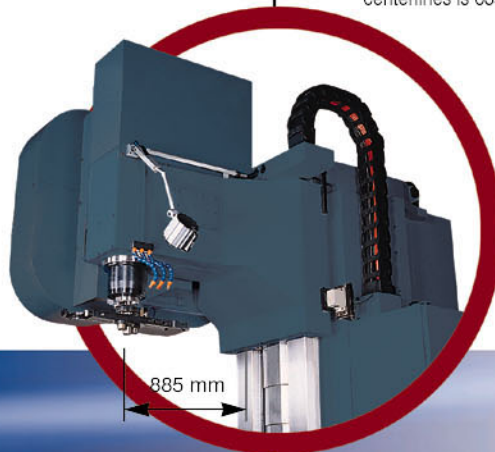

↗ **Heavy-Duty Head-HD**

- The distance between spindle center and column is 885 mm.

Symmetrical and High-rigid Structure

- High rigidity and mass Meehanite cast iron construction.
- One piece base with four guide ways.
- Turcite-B on 3 axes, best damping and strength

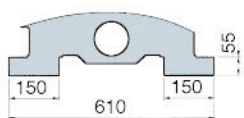

Column

- ↗ High-Quality
- ↗ High-Reliability
- ↗ High-Stability

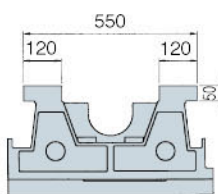

Saddle

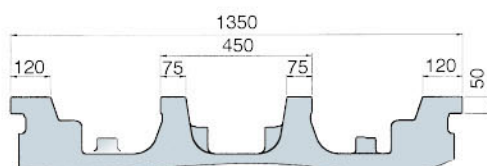

Four guide ways on base



Vertical Machining Center

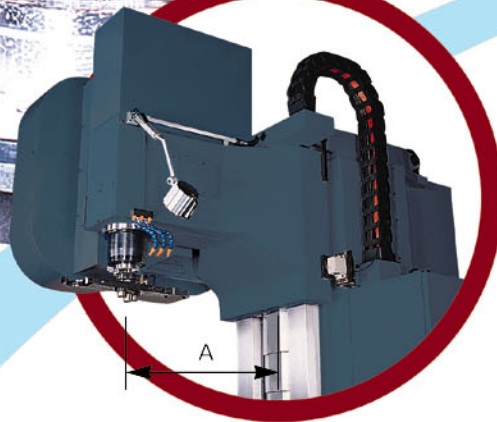

Heavy-Duty Head-HD

- Distance Between Spindle Center and Column

Model	A
VMC-1600 (No.40)	885 mm (34.8")
VMC-1600HD (No.50)	885 mm (34.8")
VMC-1600S (No.40)	1150 mm (45.3")
VMC-1600SHD (No.50)	1150 mm (45.3")

Highly Cost-Effective Machines

- Large capacity, high accuracy and rigid structure.
- Wide-machining area provides a wide range of operation.
- Maximum 4600kg (10000lb) table loading capacity ensures reliable machining of heavy workpieces.

Zero Table Overhang

- Overhang has been eliminated on all axes to ensure excellent rigidity and high machining accuracy.
- The thick-walled, well-ribbed and box-shaped casting structure.
- Hand scraped turcite-B on 3 axes ensures long term, static and dynamic accuracy.

VMC-1600 / 1600HD / 1600S / 1600SHD

Item	Model	VMC-1600	VMC-1600HD	VMC-1600S	VMC-1600SHD
Table working surface		1800 x 750 mm (70.9" x 29.5")		1800 x 1000 mm (70.9" x 39.4")	
X-axis Travel		1600 mm (63")			
Y-axis Travel		850 mm (33.5")		1100 mm (43.3")	
Z-axis Travel		800 mm (31.5")	710 mm (28")	800 mm (31.5")	
Spindle motor		11 / 7.5 kW Auto Hi-Lo	18.5 / 15 kW Auto Hi-Lo	11 / 7.5 kW Auto Hi-Lo	18.5 / 15 kW Auto Hi-Lo
Table load capacity		4600 kg (10000 lb)			
Machine dimensions (LxWxH)		4500 x 4525 x 3560 mm (177.2" x 178.1" x 140.2")		4500 x 5330 x 3675 mm (177.2" x 209.8" x 145")	
Machine weight		17500 kg (38500 lb)		18600 kg (40920 lb)	

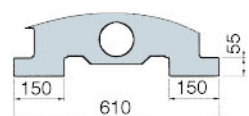

Column



SHD

() For 1600S / 1600SHD

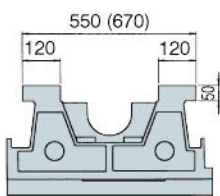

Saddle

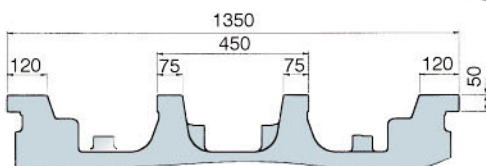

Four guide ways on base

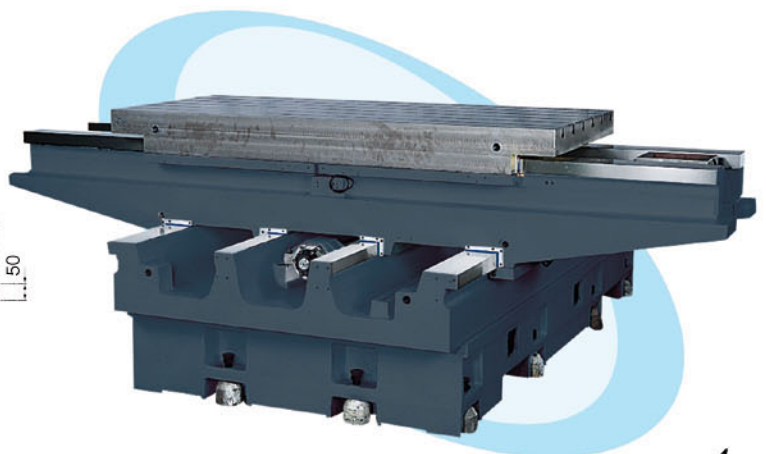

Vertical Machining Center



VMC-2000S / 2000SHD / 3000S / 3000SHD

Item	Model	VMC-2000S	VMC-2000SHD	VMC-3000S	VMC-3000SHD
Table working surface		2200 x 1000 mm (86.6" x 39.4")		3200 x 1000 mm (126" x 39.4")	
X-axis Travel		2050 mm (80.7")		3050 mm (120")	
Y-axis Travel		1100 mm (43.3")			
Z-axis Travel		800 mm (31.5")			
Spindle motor		11 / 7.5 kW Auto Hi-Lo	18.5 / 15 kW Auto Hi-Lo	11 / 7.5 kW Auto Hi-Lo	18.5 / 15 kW Auto Hi-Lo
Table load capacity		4800 kg (10500 lb)			
Machine dimensions (LxWxH)		5500 x 5330 x 3675 mm (216.5' x 209.8' x 144.7")		7700 x 5330 x 3675 mm (303" x 209.8" x 145")	
Machine weight		20000 kg (44000 lb)		23000 kg (50600 lb)	

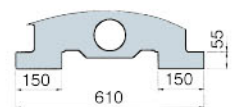

Column

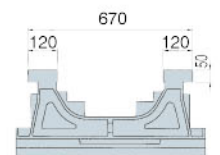

Saddle

High Total Accuracy

- The big box ways are on all 3 axes.
- The base is built with a wide distance between the guides.
- Extra wide saddle allows for full movement of the table without an overhang condition occurring.

Big Capacity for Jobs

- These machines can take a workpiece up the weight of 4800kg.
- With ZF 2-step gearbox, the high torque spindle performs a heavy cutting.

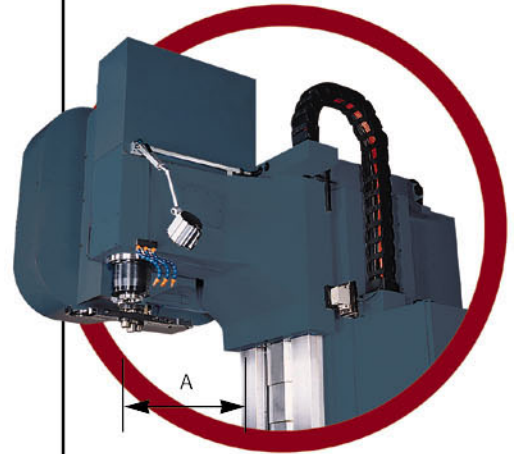

Heavy-Duty Head-HD

- Distance Between Spindle Center and Column

Model	A
VMC-2000S VMC-3000S (No.40)	1150 mm (45.3")
VMC-2000SHD VMC-3000SHD (No.50)	1150 mm (45.3")

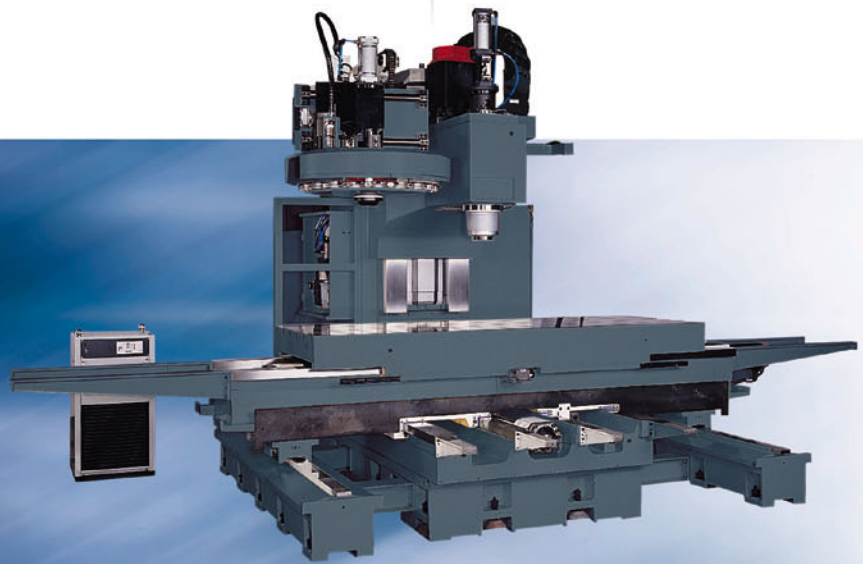
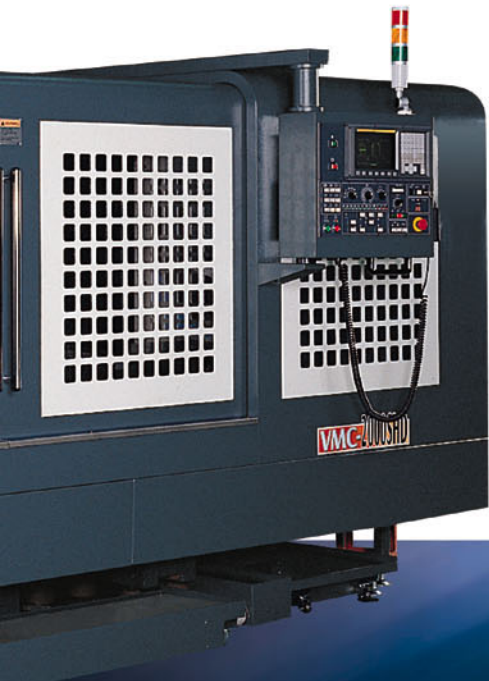

000SHD

VMC-2000S / 2000SHD

VMC-3000S / 3000SHD

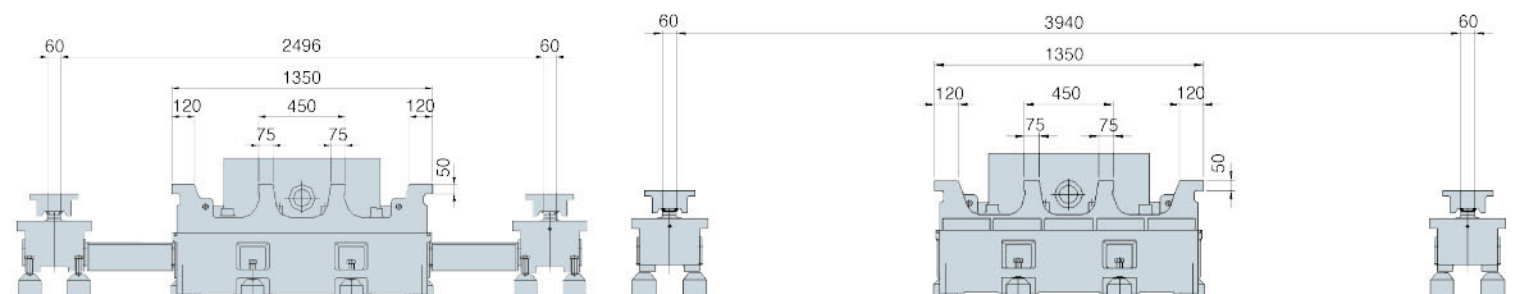

High rigid guide ways on base

Automatic Pallet Changer

Chain Type (Patented)

JOHNFORD designed, built and integrated APC is the best you will find. Our side load twin Pallet system is fast, yet heavy duty. A complete pallet exchange takes only 15 seconds, yet our heavy mechanism provides plenty of beef for fixtures and a load of parts. Our pallets are made of cast iron and are available T-slotted or drilled and tapped. Our hydraulic clamping mechanism provides twin large diameter cylinders for clamping. The pallets locate on precision ground hardened steel pins and bushings. Repeatability is excellent at .0001" !

APC Specifications	Model	VMC-1300+APC	VMC-1600+APC	VMC-1600S+APC
Pallet size (L x W)		1400 x 710 mm (55.1" x 28")	1700 x 750 mm (67" x 30")	1700 x 1000 mm (67" x 39.4")
Max. pallet load		800 kg (1762 lb)	900 kg (1982 lb)	1200 kg (2643 lb)
T-slot		18 mm (0.7")	18 mm (0.7")	18 mm (0.7")
Hydraulic clamping force		6000 kg (13216 lb)	9000 kg (19824 lb)	9000 kg (19824 lb)
Pallet change time		20 sec	25 sec	25 sec

➔ VMC-1600HD+APC



Mechanical Design Features

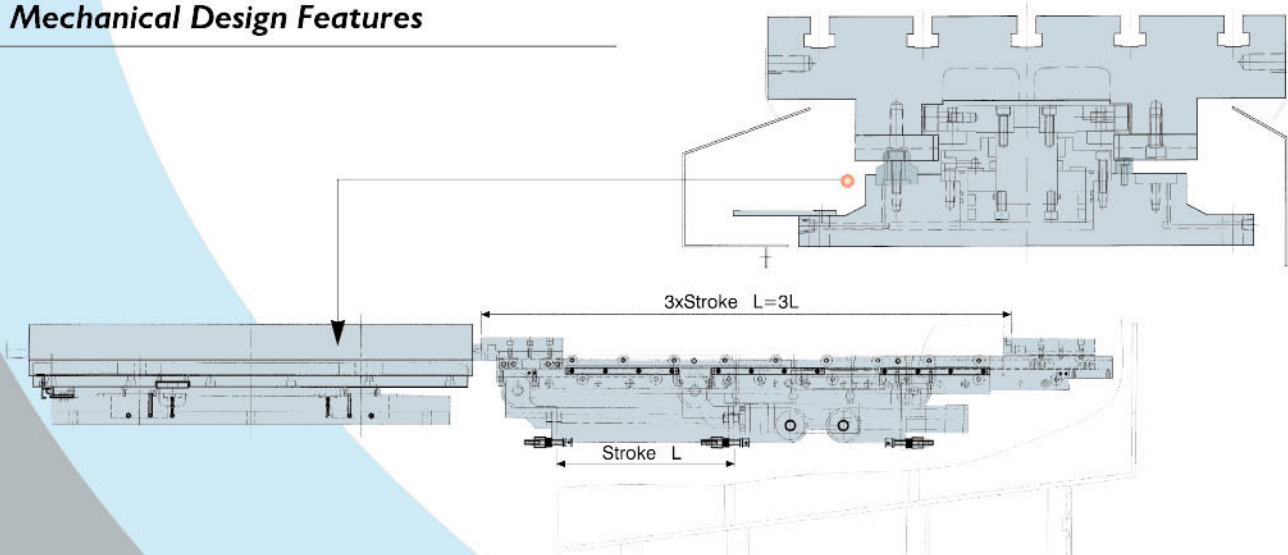

Spindle Power & Torque Chart

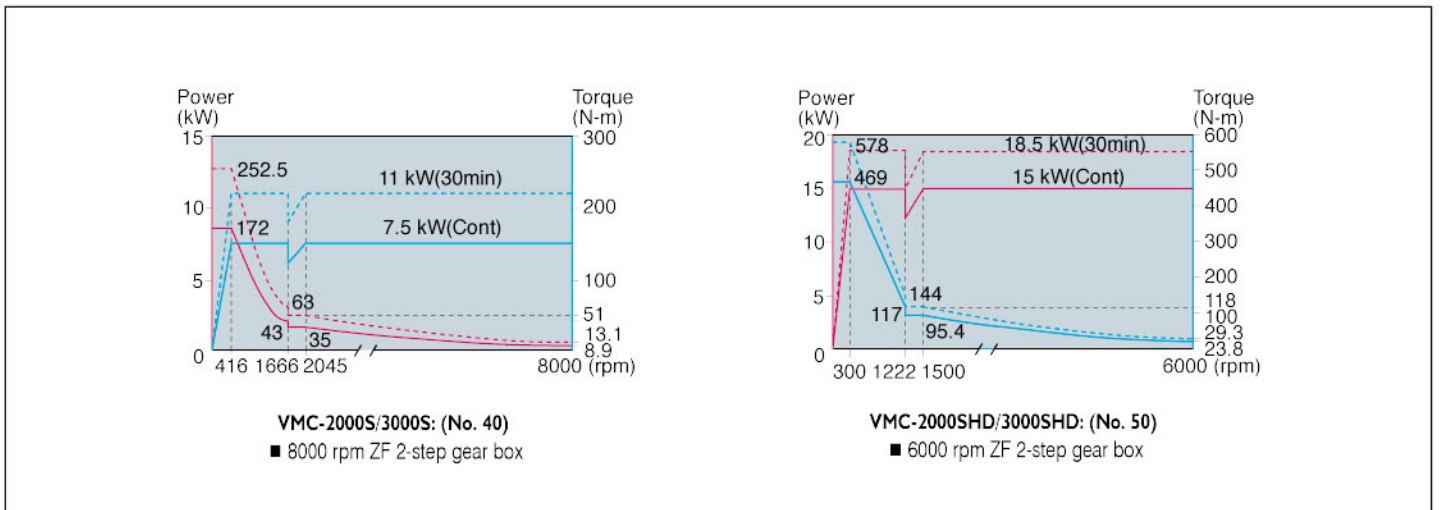
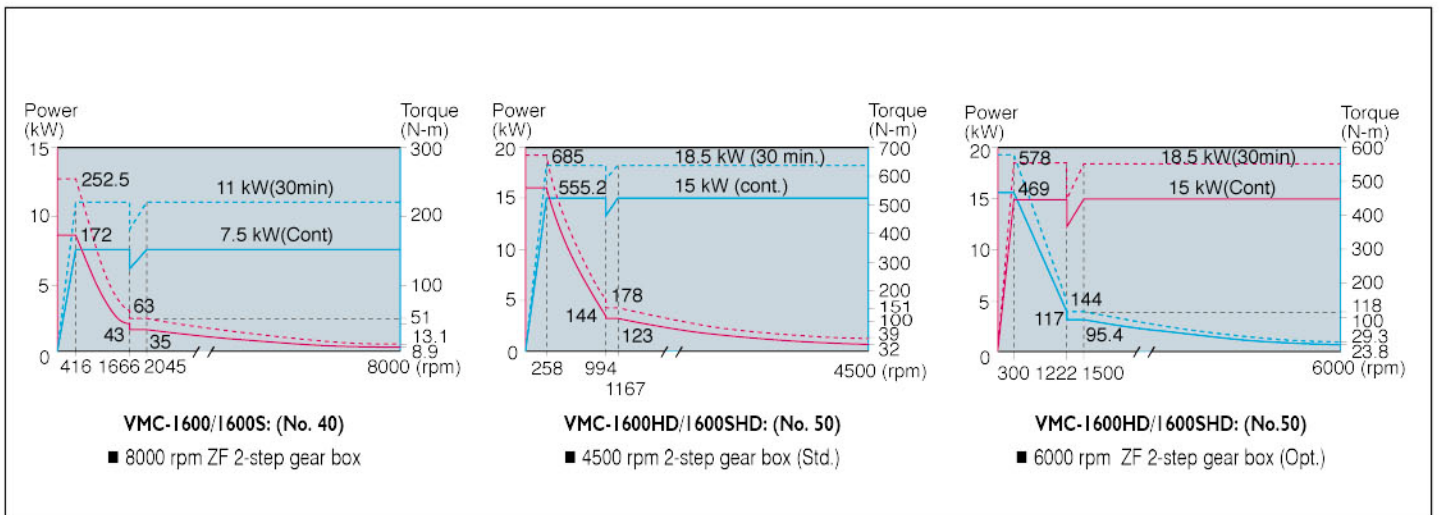
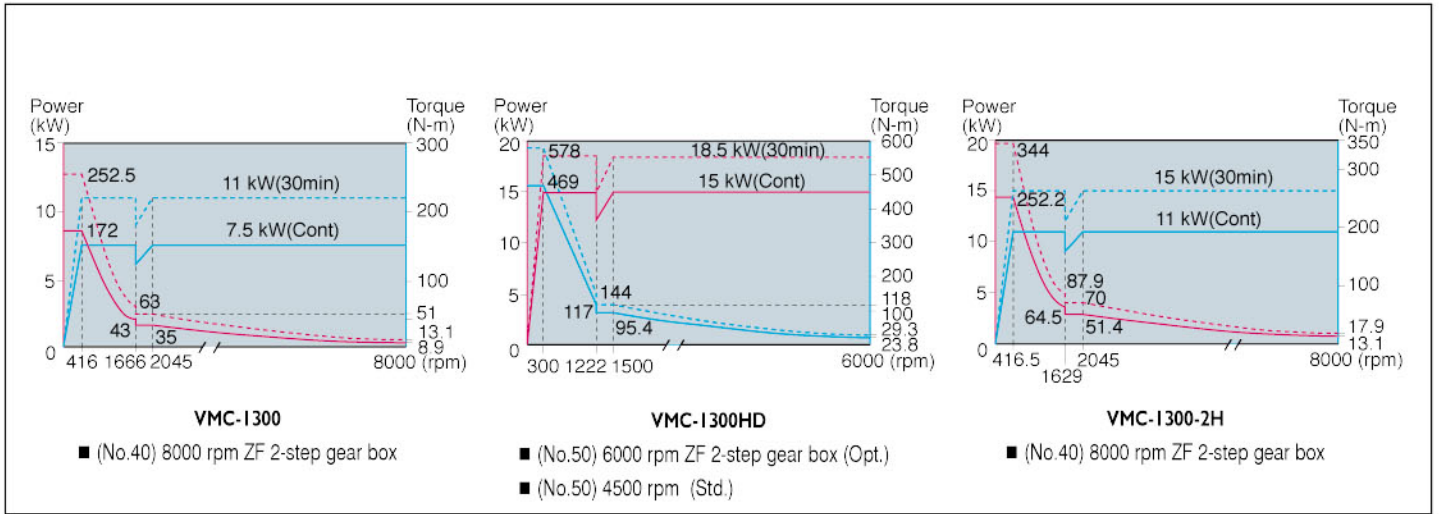

Different Accessories for Your C

ATC Units

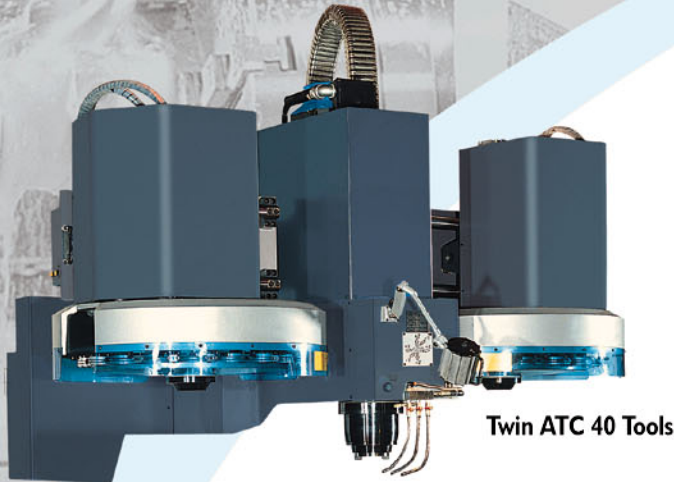

Twin ATC 40 Tools

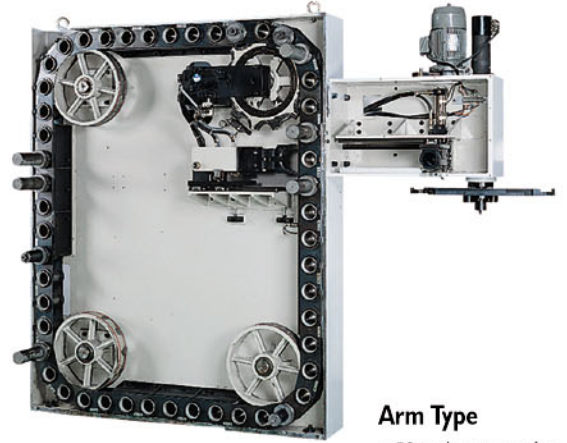

Arm Type

- 50 tools or more for BT/CAT 40, BT/CAT 50



Armless Type

- 24 tools for BT/CAT-40
- 20 tools for BT/CAT-50

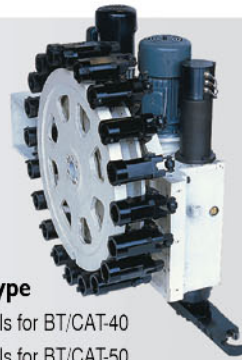

Arm Type

- 24 tools for BT/CAT-40
- 24 tools for BT/CAT-50

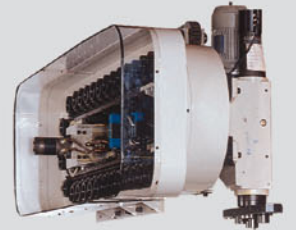

Arm Type

- 32 tools for BT/CAT-40, BT/CAT-50

Gear Box

- Delivers high torque.
- ZF 2 speed automatic gear box,
- No noise generated,
- No heat transmitted,
- No gear vibration,
- High efficiency (over 95%)

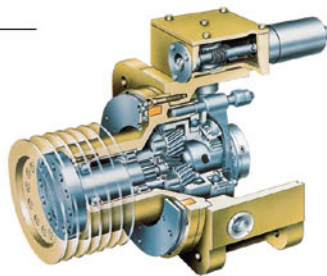

Cooler

- High efficiency.
- Powerful cooling performance.



Standard Features-Great Equipment

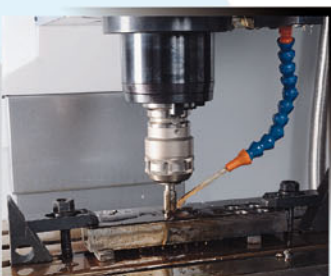

Rigid tapping



High pressure coolant
(P:3.5 kg/cm², Q:100 l/min)



Automatic chip removal
(Screw type chip conveyor)



Remote handwheel

Tool System

Pull Stud

BT-40

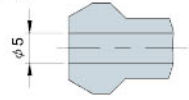

for C.T.S.

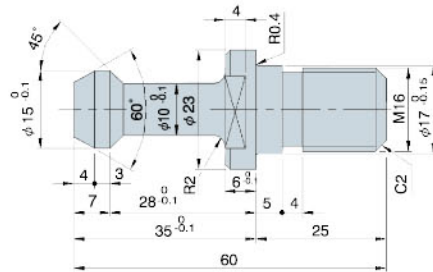

BT-50 / CAT-50

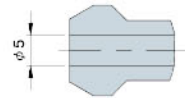

for C.T.S.

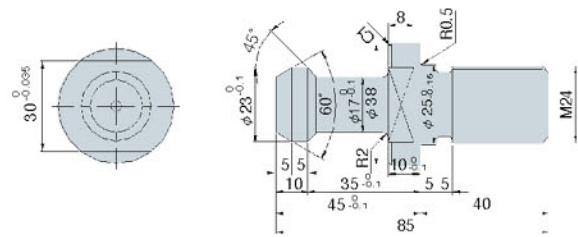

CAT-40



for C.T.S.

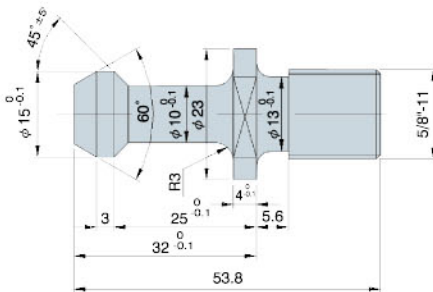

Tool Shank (Std.)

BT-40

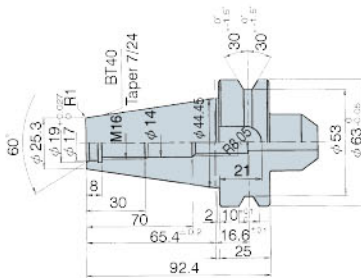
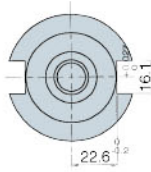

BT-50

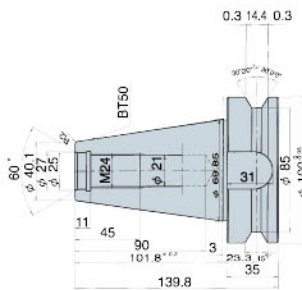
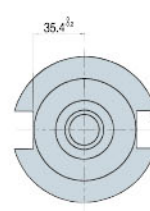

CAT-40

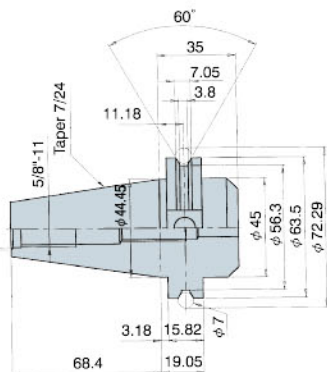
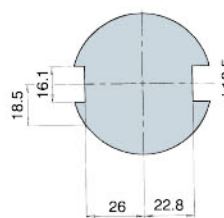

CAT-50

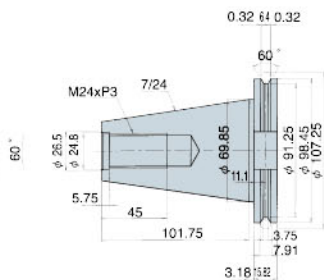
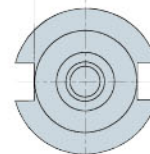

Coolant Thru Spindle

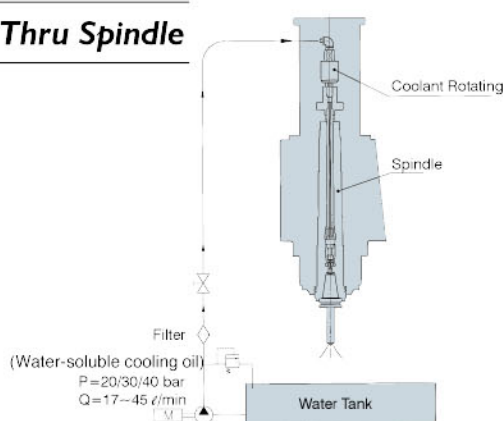

Coolant Thru Tool Tip

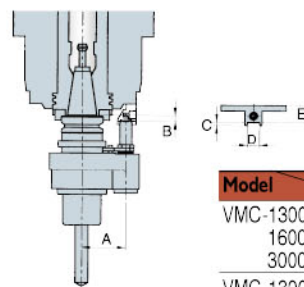

Model	Item	Taper No.	A	B	C	D	E
VMC-1300/1300-2H 1600/2000S 3000S	No. 40		65	9	5	18	25.5
			80	23.5	5	18	36.5
VMC-1300HD/1600HD 2000SHD/ 3000SHD	No. 50		80	23.5	5	18	36.5

Dimensions

VMC-1300/1300HD/1600/1600HD

() for VMC-1300/1300HD

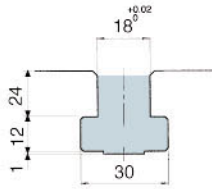

T-Slot

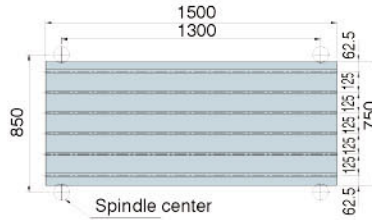

Table (VMC-1300/1300HD)

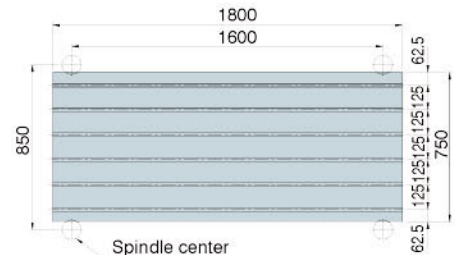
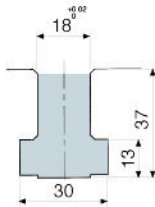

Table (VMC-1600/1600HD)

VMC-1600S/1600SHD/2000S/2000SHD/3000S/3000SHD

() for VMC-2000S/2000SHD [] for VMC-3000S/3000SHD



T-Slot

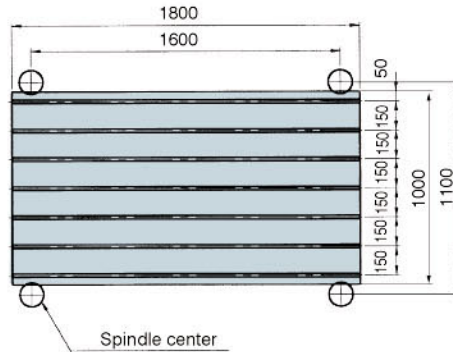

Table (VMC-1600S/1600SHD)

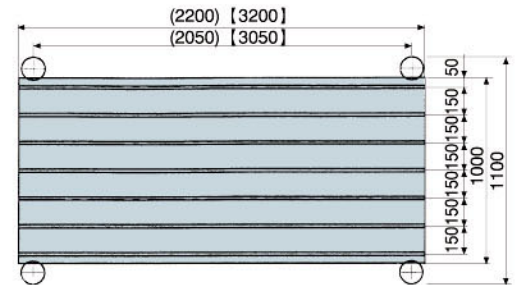
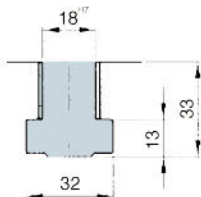

Table (VMC-2000S/3000SHD)

VMC-1300/1600+APC

Unit: mm

Model \ Item	A	B	C	D	E	F	G	H	I	J	K	L	W
VMC-1300+APC	1320	5132	850	3445	1690	1305	1910	1275	3065	480	3180-3890	1400	710
VMC-1600+APC	1720	6100	850	4185	1915	1276	1880	1250	3065	480	2955-3665	1700	750



T-Slot

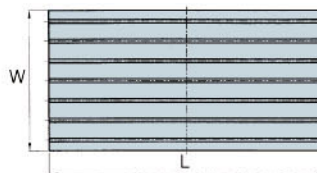

Table

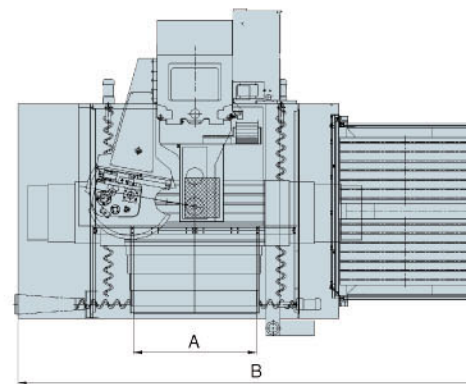

Top View (floor space required)

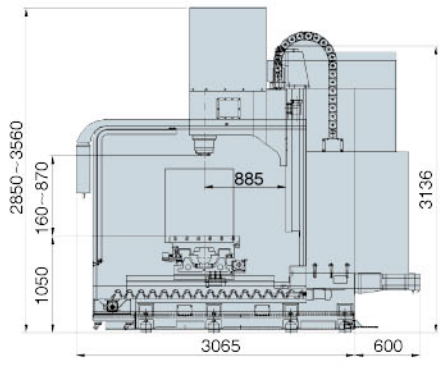
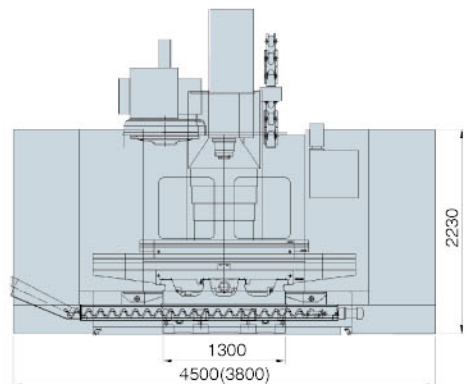
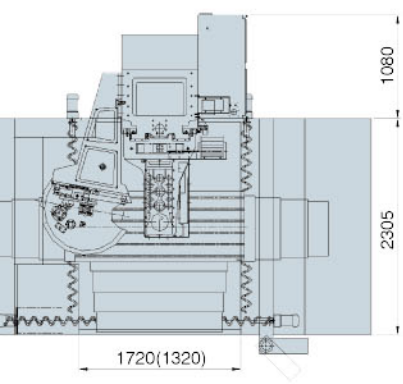

Top View (floor space required)

Front View

Side View

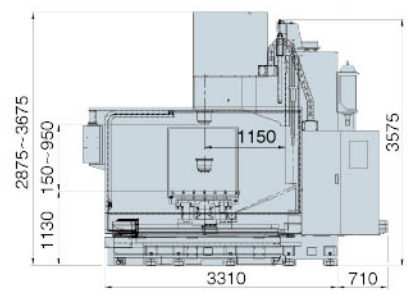
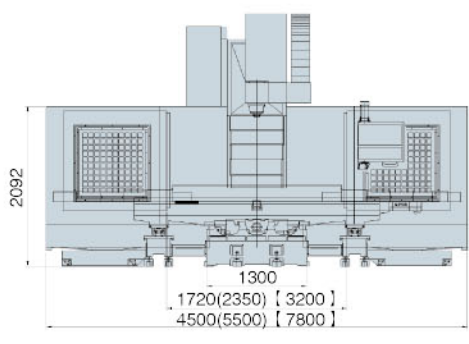
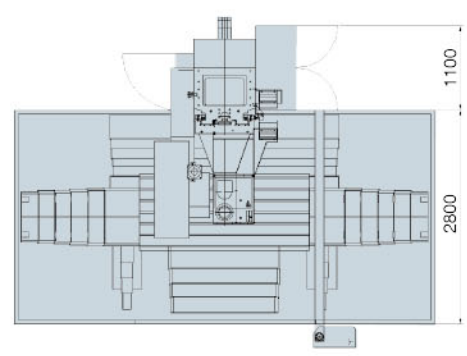

Top View (floor space required)

Front View

Side View

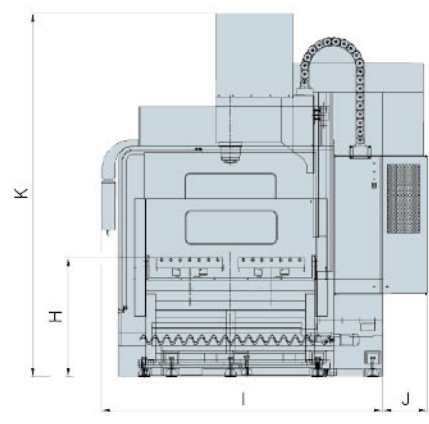
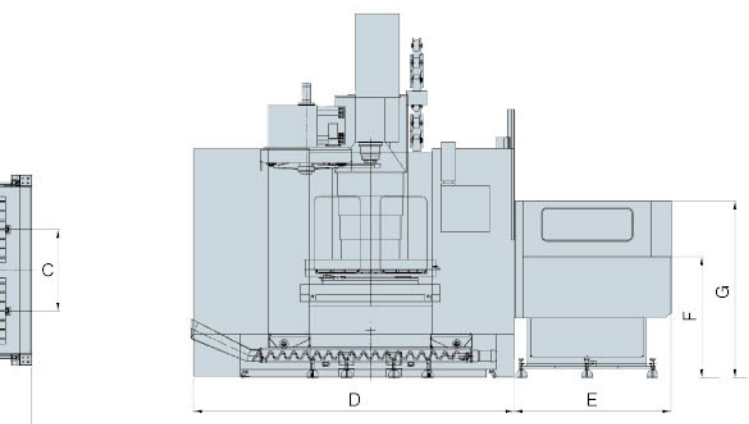

Front View

Side View

Specifications

Item	Model	No.40	VMC-I300-2H	VMC-I300	VMC-I600	VMC-I600S	VMC-2000S	VMC-3000S	
		No.50		I300HD	I600HD	I600SHD	2000SHD	3000SHD	
Table working surface (mm)			1500x750 (59.1" x 29.5")		1800 x 750 (70.9" x 29.5")	1800 x 1000 (70.9" x 39.4")	2200 x 1000 (86.6" x 39.4")	3200 x 1000 (126" x 39.4")	
Longitudinal travel (X) (mm)			1300 (51.2")		1600 (63")		2050 (80.7")	3050 (120")	
Cross travel (Y) (mm)			850 (33.5")			1100 (43.3")			
Vertical travel (Z) (mm)	No.40		710 (28")	800 (31.5")					
	No.50			710 (28")		800 (31.5")			
Spindle nose to table (mm)	No.40		160-870 (6.3" -34.3")	150~950 (5.9" -37.4")		150~950 (5.9"~37.4")			
	No.50			160~870 (6.3" -34.3")					
Spindle center to column (mm)			885 (34.8")	885 (34.8")		1150 (45.3")			
Distance between two spindles (mm)			635 (25")						
Spindle taper			BT-40 / CAT-40		For VMC- 1300 1600 1600S 2000S 3000S	BT-50 / CAT-50		1300HD 1600HD For VMC- 1600SHD 2000SHD 3000SHD	
Spindle diameter (mm)			70 (2.8")			100 (3.9")			
Spindle speed (rpm)			Auto Hi-Lo Gear 80-8000			Auto Hi-Lo Gear 10-4500			
Spindle motor (kW)			11 / 15	7.5 / 11		15 / 18.5			
X-Y-Z Rapid traverse (m/min)			18-18-12				15-15-12	12-12-12	
Cutting feed (mm/min)			1-12000				1-8000		
No. of tools			Armless 24x2	BT-40 / CAT-40: Armless 24, Arm type 24 / 32 (Opt.)			BT-50 / CAT-50: Armless 20, Arm type 24 / 32 (Opt.)		
Adjacent pockets Max. tool dia. (mm)			75 (3")	BT-40 / CAT-40 For VMC- 1300 1300-2H 1600 1600S 2000S 3000S		125 (5")	BT-50 / CAT-50 For VMC- 1300HD 1600HD 1600SHD 2000SHD 3000SHD		
Max. tool diameter (mm)		100 (3.9")	250 (9.8")						
Max. tool length (mm)		320 (12.6")	400 (15.7")						
Max. tool weight (kg)		10 (22 lb)	15 (33 lb)						
Table load capacity (kg)			3270 (7194 lb)		4600 (10120 lb)		4800 (10560 lb)		
Machine weight (kg)			14000 (30800 lb)	13500 (29700 lb)	17500 (38500 lb)	18600 (40920 lb)	20000 (44000 lb)	23000 (50600 lb)	
Machine dimensions (LxWxH) (mm)			3800 x 4525 x 3220 (149.6"x178.1"x127")	3800 x 4525 x 3560 (149.6"x178.1"x140.2")	4500 x 4525 x 3560 (177.2"x178.1"x140.2")	4500 x 5330 x 3675 (177.2"x209.8"x145")	5500 x 5330 x 3675 (216.5"x209.8"x145")	7700 x 5330 x 3675 (303"x209.8"x145")	
X-Y-Z Ball screw dia.			φ 50, φ 50, φ 50			φ 50, φ 63, φ 50		φ 63, φ 63, φ 50	
Cutting capacity (S45C)	milling (cc/min)		160	180	For VMC- 1300 1600 1600S 2000S 3000S	320	For VMC- 1300HD 1600HD 1600SHD 2000SHD 3000SHD		
	drilling (mm)		φ 30	φ 40		φ 52			
	tapping		M24 x P3.0	M30 x P3.5		M50 x P4.5			

■ All data subject to change without notice.

■ All the specifications are listed with the FANUC CNC system.

Standard Accessories:

1. Coolant system
2. Spindle air blast
3. Auto lubrication with alarm
4. LED working lamp
5. Tools, tool box and various manuals
6. Twin spindle/ Twin ATC (VMC-1300-2H)
7. Screw type chip conveyor
8. Full enclosure splash guard
9. Spindle cooler unit (for VMC-HD,SHD series)
10. FANUC 0i-MD Controller

Optional Accessories:

1. Contact / non-contact tool setting system
2. CNC Rotary table
3. Automatic pallet changer (for VMC-1300/HD, 1600/HD)
4. Twin ATC (for VMC-1300)
5. High pressure coolant thru tool tip
6. High pressure coolant thru spindle (20 bar/30 bar)
7. Chain type chip conveyor
8. Manual guide *i* / 0*i* (0*i*MD) ; Manual guide *i* (31*i*MB)

CNC Control Specs

■ CNC system type

O: Std. Δ: Opt. -: Nil

Type	Model	VMC Series
FANUC 0i/MD		○
FANUC 31i/MB		Δ
Heidenhain i/TNC530 HSCI		Δ
Siemens 840D		Δ
Siemens 828D		Δ

■ Fanuc specifications

O: Std. Δ: Opt. -: Nil

	Item	Specifications	0iMD	31iMB	
Display unit	8.4" color LCD		○	-	
	10.4" color LCD		Δ	○	
Function	Data Server with 2GB CF card		Δ	Δ	
	AICC II		Δ	○	
	High speed processing		-	Δ	
	Conversational programming with graphic function	Manual guide 0i	0iMD	○	-
		Manual guide i	31i/MB / 0iMD (10.4" LCD)	Δ	○
NC program memory	1280 meter (about 512 KB)		○	○	

■ Siemens specifications

O: Std. Δ: Opt. -: Nil

	Item	Specifications	828D	840D
Operation Panel	10.4" color LCD		○	○
	15.1" color LCD		-	Δ
	Machine panel MCP483C		○	○
	TCU without hard disk	CF card	○	○
	PCU 50 with hard disk		-	Δ
Function	Ethernet		○	○
	ShopMill programming		○	Δ
	Automatic residual material detection		Δ	Δ
	Universal interpolator NURBS		○	○
	Spline interpolation for 3 - axes		Δ	Δ

■ Heidenhain specifications

O: Std. Δ: Opt. -: Nil

	Item	Specifications	iTNC530 HSCI
Display unit	Visual display unit 15" TFT display		○
Function	Main computer	0.5 ms block processing time	○
	NC programming memory	21 GB on SSDR	○
Software option 1	<ul style="list-style-type: none"> • Cylindrical surface interpolation • Feed rate in mm/min • Tilting the working plane • Circular interpolation in 3 axes with tilted working plane • HSC path control with special nominal-position value filters 		Δ
Software option 2	3-D machining <ul style="list-style-type: none"> • Motion control with minimum jerk • 3-D tool compensation through surface normal vectors • TCPM: Tool center point management • Keeping the tool normal to the contour • Tool radius compensation normal to the tool direction • Manual traverse in the active tool-axis system Interpolation <ul style="list-style-type: none"> • Linear in 5 axes (Subject to export permit) • Spline: execution of splines (3rd degree polynomial) 		Δ





**Whatever You Need
for Milling and Turning
We Offer the Best.**



ROUNDTOP MACHINERY INDUSTRIES CO., LTD.

No. 1056, Zhongshan Rd., Shengang Dist.,

Taichung City 42952, Taiwan (R.O.C.)

Tel : 886-4-2562-4721

Fax: 886-4-2561-3886

<http://www.johnford.com.tw>

E-mail: johnford@johnford.com.tw